



▶▶ CONGRESS PARK HANAU

MORE THAN JUST A
LOCATION

meetings

congresses

cultural events



LIVE COMMUNICATION

CONCERTS & CULTURAL EXPERIENCES



We bring
people together.

on 4,000 sqm

11 halls & 5 foyers



consistently
sustainable



live,
digital, hybrid



Brothers
Grimm
Hall

PLENTY OF ROOM FOR
YOUR EVENT IDEAS

Brothers Grimm Hall

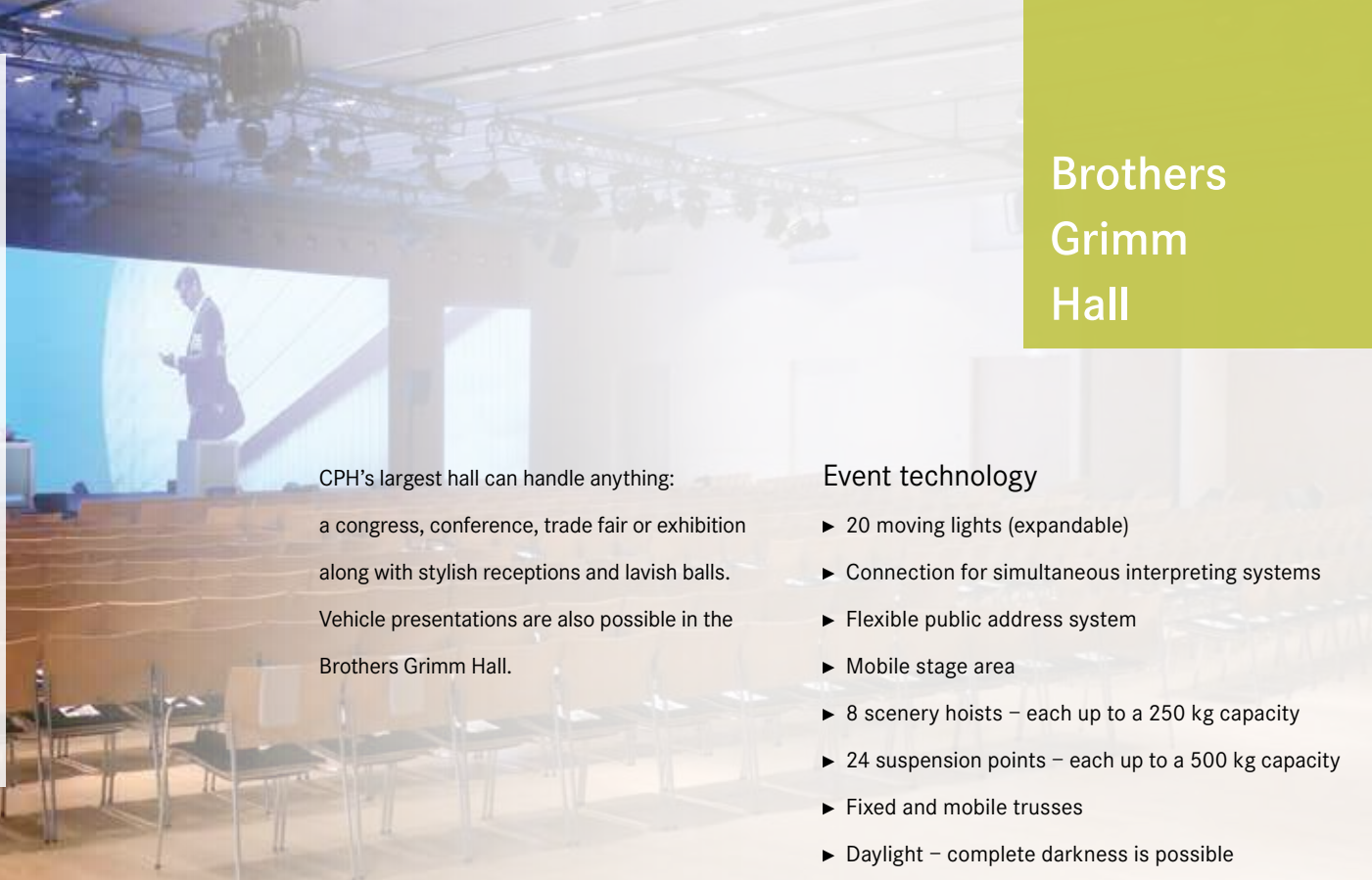
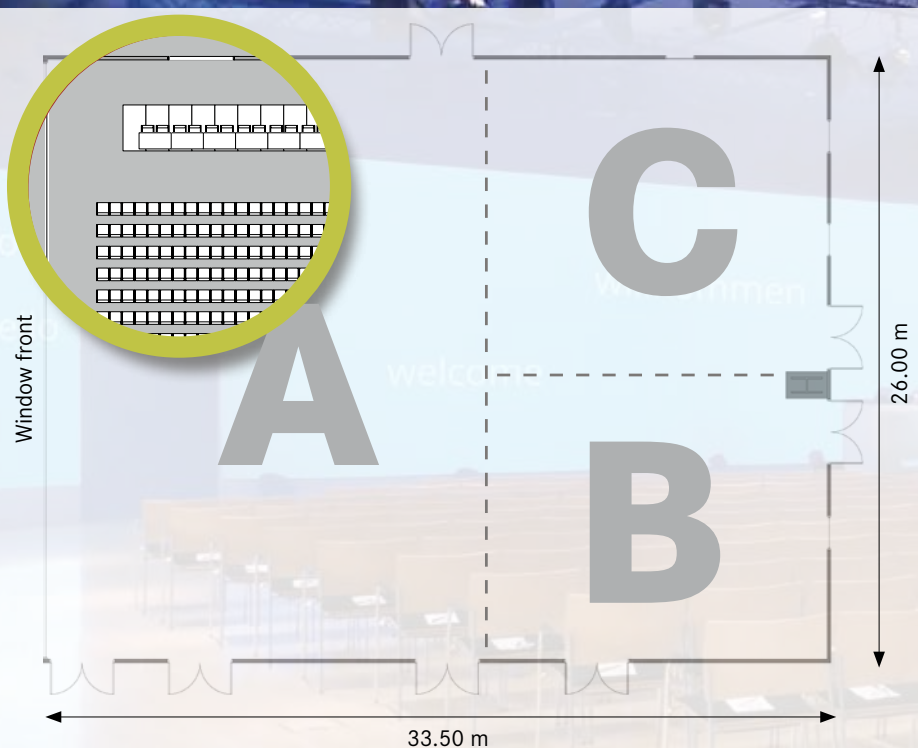

CPH's largest hall can handle anything:

a congress, conference, trade fair or exhibition along with stylish receptions and lavish balls.

Vehicle presentations are also possible in the Brothers Grimm Hall.

Event technology

- ▶ 20 moving lights (expandable)
- ▶ Connection for simultaneous interpreting systems
- ▶ Flexible public address system
- ▶ Mobile stage area
- ▶ 8 scenery hoists – each up to a 250 kg capacity
- ▶ 24 suspension points – each up to a 500 kg capacity
- ▶ Fixed and mobile trusses
- ▶ Daylight – complete darkness is possible
- ▶ Dimmer connections
- ▶ Signal box and control room
- ▶ Freight elevator with up to a 6,000 kg capacity
- ▶ Vehicle accessible

A MULTI-FUNCTIONAL

ALL-ROUNDER



Capacities	sqm	Height	Row	Parliament	Banquet
Total	871	6.00	1,033	448	612
Section A	491	6.00	513	260	336
Section B	185	6.00	180	96	140
Section C	192	6.00	200	98	140

Paul
Hindemith
Hall

BEST ACOUSTICS

IN A STYLISH AMBIENCE



Paul Hindemith Hall

A big stage for both the classic and the modern. From symphony concerts to musicals, theatre to comedy – the concert and theatre hall with its remarkable acoustics offers excellent conditions for any kind of cultural event. Thanks to its stylish ambience, the Paul Hindemith Hall is also often booked for congresses, receptions or banquets.

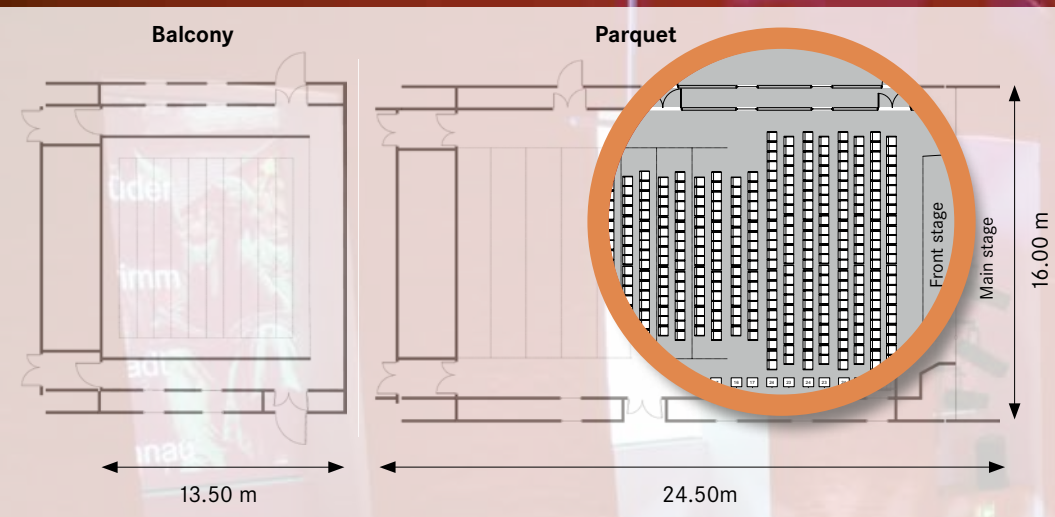

A STAGE OPEN FOR CULTURE, FESTIVALS & EVENTS

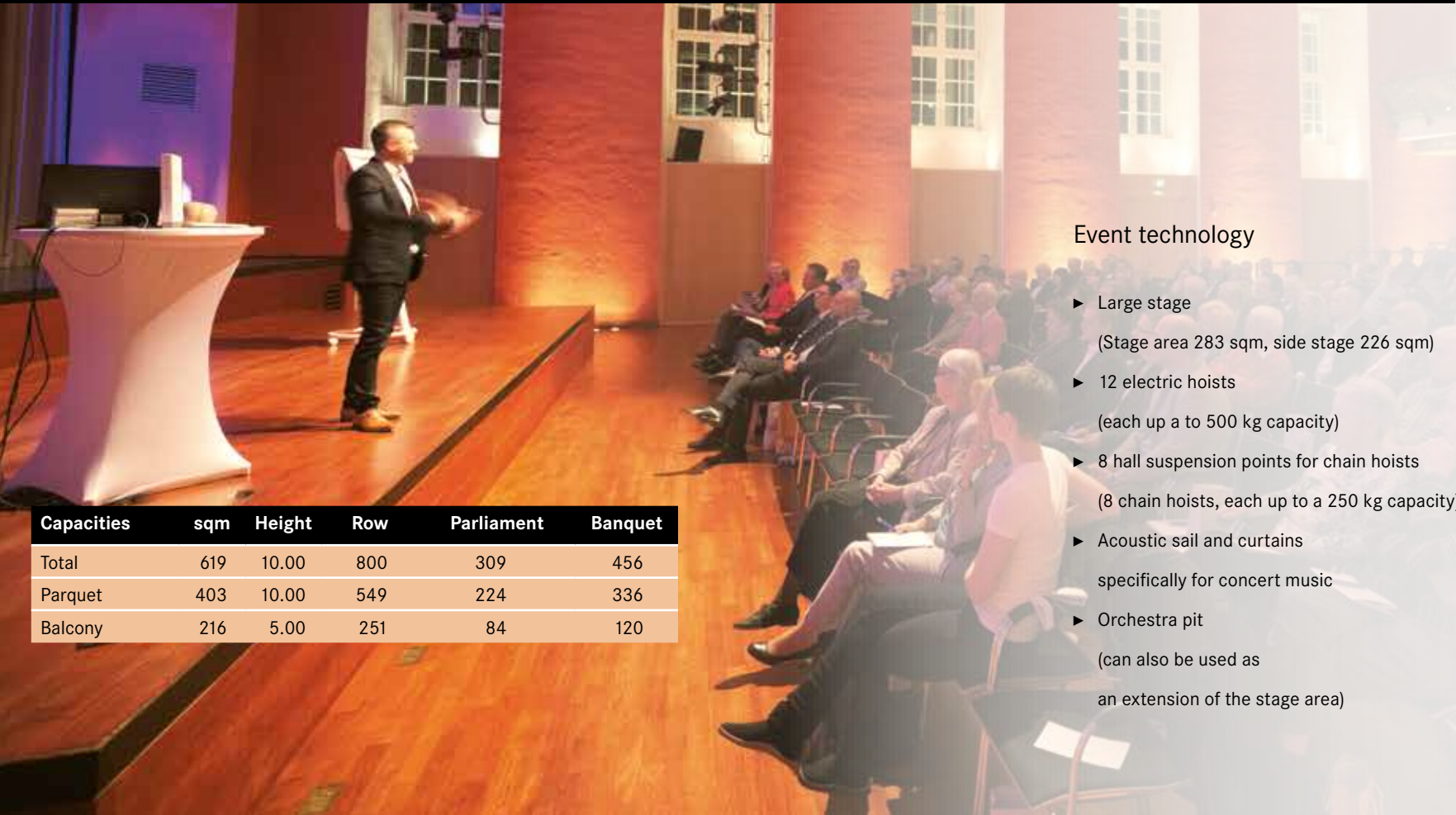

Event technology

- ▶ Large stage
(Stage area 283 sqm, side stage 226 sqm)
- ▶ 12 electric hoists
(each up to a 500 kg capacity)
- ▶ 8 hall suspension points for chain hoists
(8 chain hoists, each up to a 250 kg capacity)
- ▶ Acoustic sail and curtains
specifically for concert music
- ▶ Orchestra pit
(can also be used as
an extension of the stage area)
- ▶ Fixed and mobile trusses
- ▶ Daylight – complete darkness is possible
- ▶ Dimmer connections
- ▶ Signal box and control room
- ▶ Variable seating in the auditorium
(incl. lifting platform)
- ▶ Iron curtain,
curtain hoist with up to a 300 kg capacity
and main curtain
- ▶ Orchestra seating incl. music stands
- ▶ 13 artists' dressing rooms

Capacities	sqm	Height	Row	Parliament	Banquet
Total	619	10.00	800	309	456
Parquet	403	10.00	549	224	336
Balcony	216	5.00	251	84	120

Landgrave
Alexander
Friedrich
von Hessen Hall

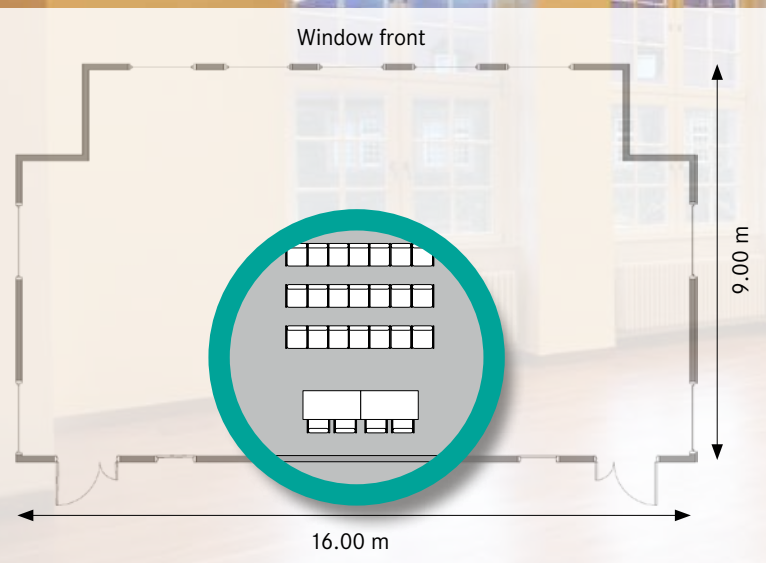

The chamber music hall possesses an impressive historical charm and is recommended for conferences and lectures in an exclusive setting. The view of the historic Schlossplatz also makes it popular for receptions and banquets. Its excellent acoustics also provide fantastic conditions for small music events.

Facts & figures

- ▶ PA system
- ▶ Motorised screen in the ceiling
- ▶ Various room lighting moods
- ▶ Daylight – complete darkness is possible
- ▶ Meeting equipment

**IT'S A CLASSIC,
NOT JUST FOR MUSIC**

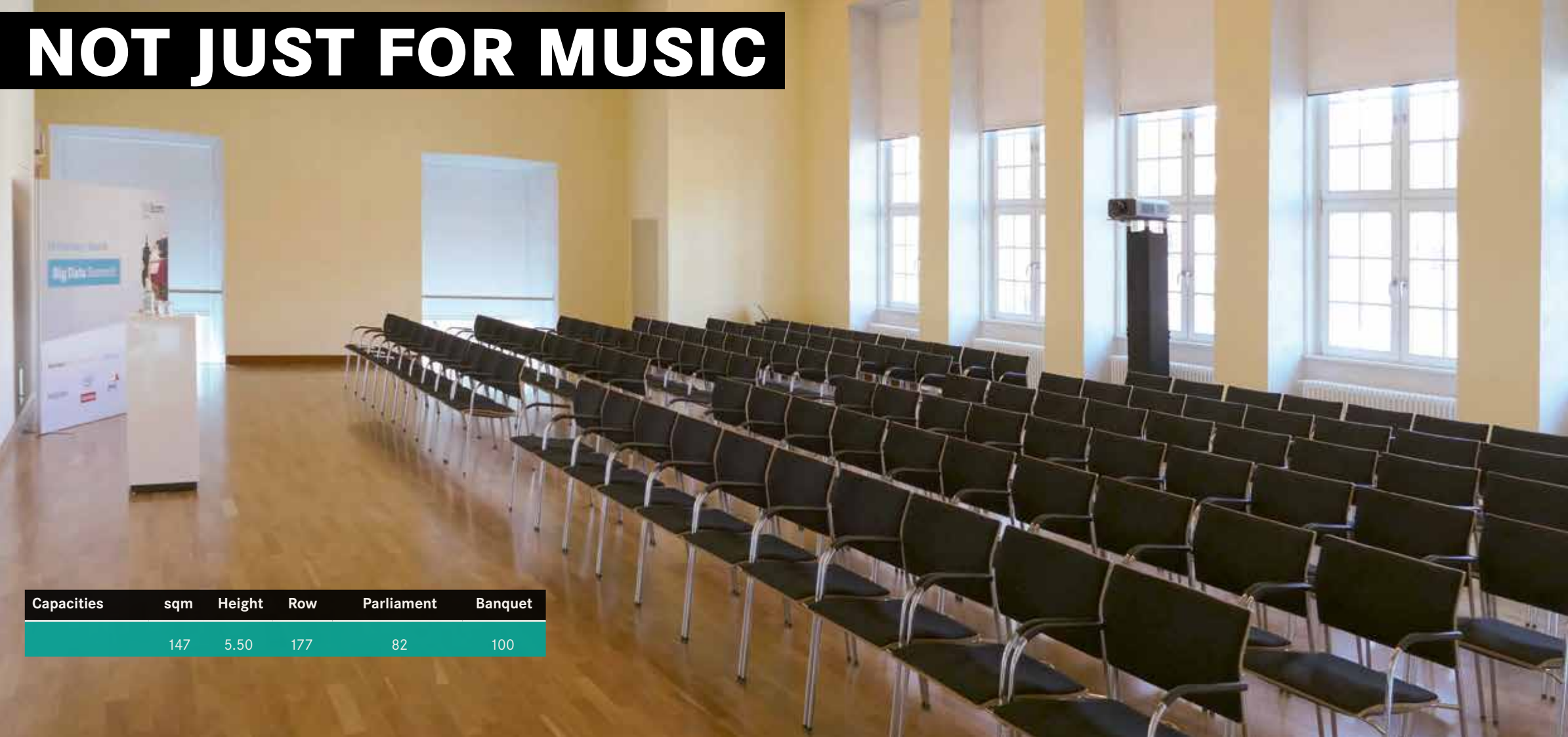

Capacities	sqm	Height	Row	Parliament	Banquet
	147	5.50	177	82	100

Conference rooms

The five conference rooms on the ground floor can be flexibly combined, offering row seating for 35 to 144 seats and direct access to the Schlossgarten.

In addition to being used as breakout rooms, seminars, lectures and social events can also be held here.

Facts & figures

- ▶ Motorised screen in the ceiling
- ▶ Permanently installed projector
- ▶ PA system
- ▶ Various lighting moods
- ▶ Daylight – complete darkness is possible
- ▶ Meeting equipment

MEETING WITH A VIEW OF GREENERY

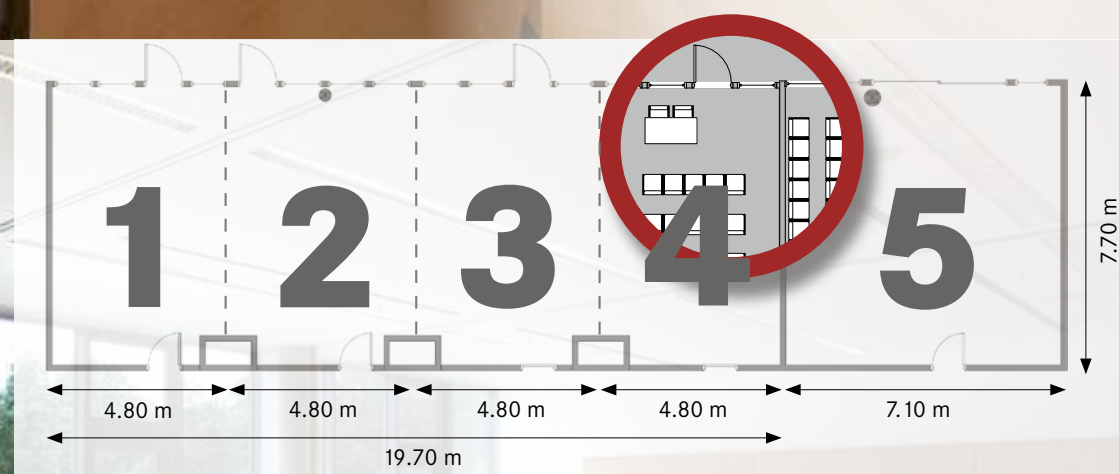

Capacities	sqm	Height	Row	Parliament	U shape	Banquet
Conference room 1	37	3.20	35	12	10	
Conference room 2	37	3.20	35	12	10	
Conference room 3	37	3.20	35	12	10	
Conference room 4	37	3.20	35	12	10	
Conference room 5	55	3.20	55	24	14	
C 1-2/2-3/3-4	75	3.20	63	24	20	
C 1-3 bzw. 2-4	114	3.20	99	42	32	
C 1-4	151	3.20	144	60	48	88

Foyers

More than 2,000 sqm for everything that needs room: trade fairs and exhibitions, catering, get-togethers and networking events. The five foyers in the CPH can be combined with different rooms or also used on their own. Each foyer has its own character – from modern to historic to 50s' charm. The choice is yours!

**MORE THAN JUST
ADDITIONAL AREAS**





Foyers

**STYLISH, 50s' CHARME
OR HISTORIC**



Foyer areas	sqm
Entrance Foyer (ground floor)	531
Anton Wilhelm Tischbein Foyer (upper floor)	298
Intermediate Foyer (ground floor)	408
Henriette Westermayr Foyer (ground floor)	427
Klaus Remer Foyer (ground floor)	259

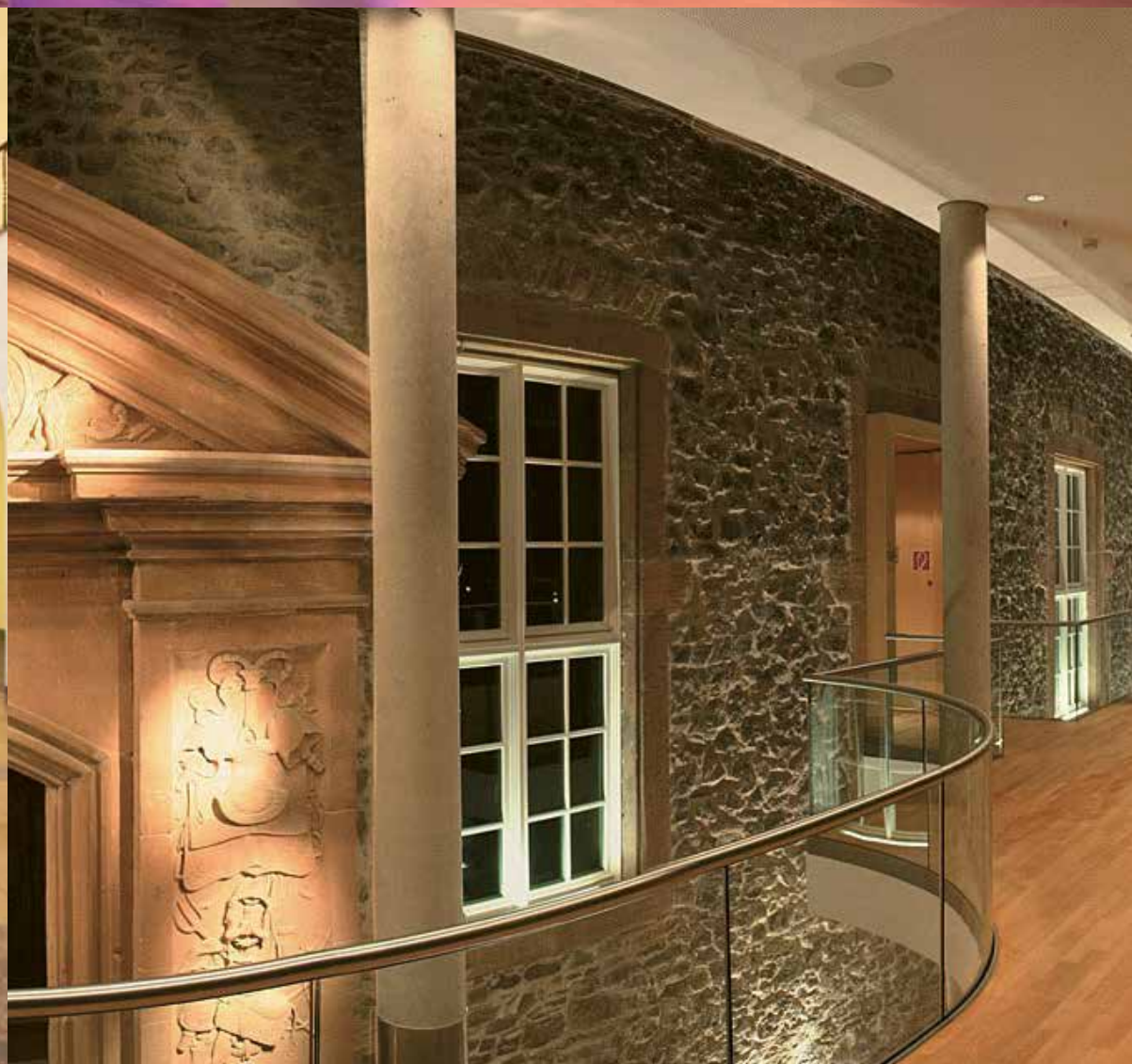

CPH Lounge

Whether it is for a social event, small-scale meetings, or exclusive networking, the CPH Lounge offers a stylish ambience. Its striking architecture also makes it an exciting scenery for live streaming events.

EXCLUSIVE SPACE

FOR NETWORKING & LIVE STREAMING

Facts & figures

- ▶ Separate access to the building
- ▶ Direct exit to the Schlossgarten
- ▶ Flexible seating
- ▶ Various lighting moods
- ▶ Daylight
- ▶ Integrated bar counter

Capacity	sqm	Height	Row	Banquet
100	3.20	40	70	



CONGRESS PARK HANAU

FLOOR PLANS

Upper floor

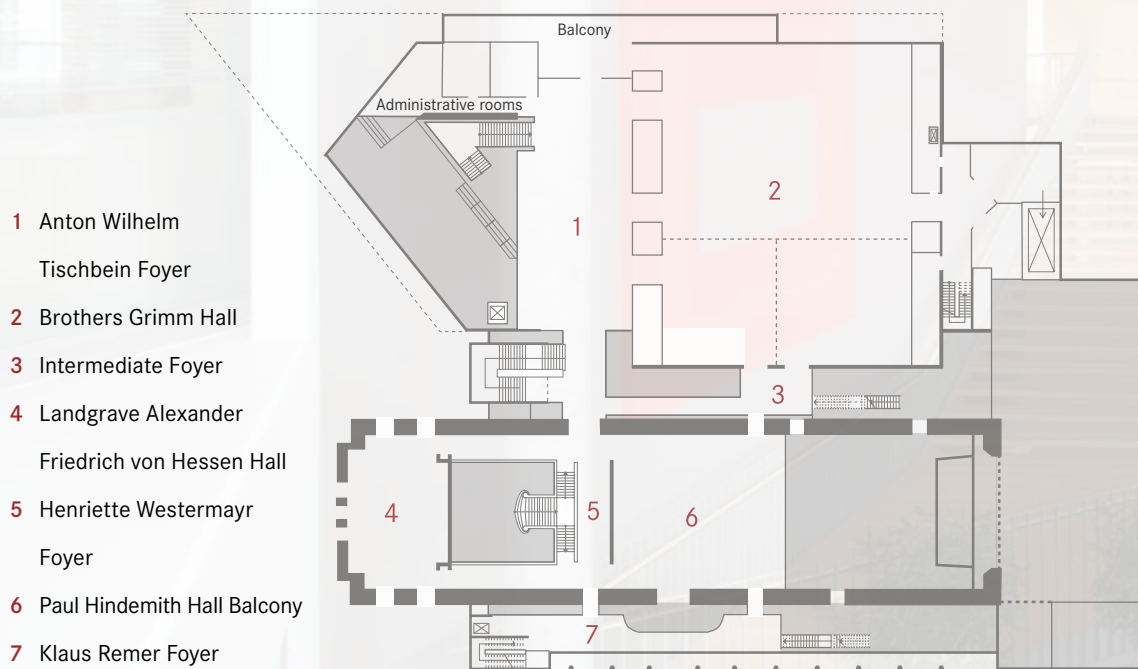

Ground floor

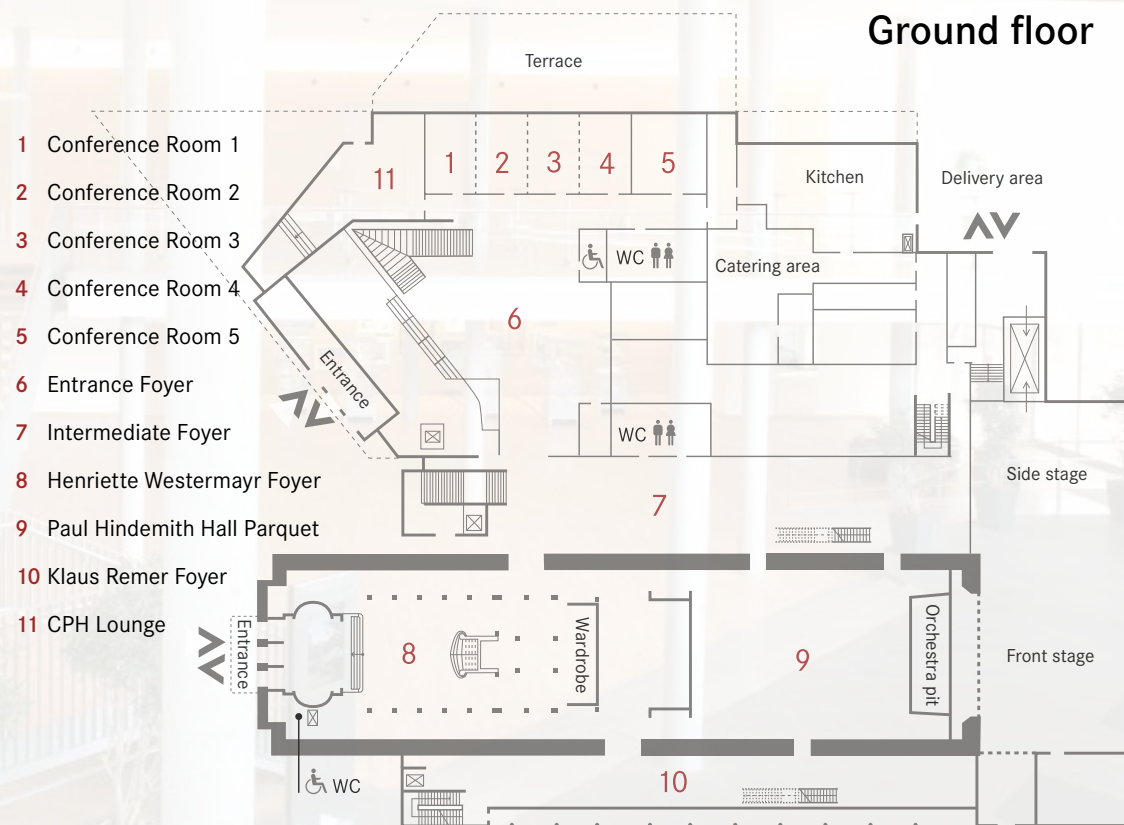

NEW FORD
FOCUS
#1
 ...JUST GOT BETTER

More than just a location

The exceptionally stylish rooms, perfect technical equipment, and the qualified, highly dedicated team make every occasion at the Congress Park Hanau a unique event.

OVERVIEW

CAPACITIES

Foyers	sqm
Entrance Foyer	531
Anton Wilhelm Tischbein Foyer (upper floor)	298
Intermediate Foyer (ground floor)	408
Henriette Westermayr Foyer (ground floor)	427
Klaus Remer Foyer (ground floor)	259

Brothers Grimm Hall						
	sqm	Height	Row	Parliament	Banquet	Reception
Total	871	6.00	1,033	448	612	1,200
Section A	491	6.00	513	260	336	600
Section B	185	6.00	180	96	140	300
Section C	192	6.00	200	98	140	300

Paul Hindemith Hall (partly ascending)						
	sqm	Height	Row	Parliament	Banquet	Reception
Total	619	10.00	800	309	456	1,031
Parquet	403	10.00	549	224	336	780
Balcony	216	5.00	251	84	120	251

Landgrave Alexander Friedrich von Hessen Hall						
	sqm	Height	Row	Parliament	Banquet	Reception
Total	147	5.50	177	82	100	280

Conference rooms						
	sqm	Height	Row	Parliament	Banquet	Reception
C 1,2,3,4 separate	37	3.20	35	12		
C 1-4	155	3.20	144	60	88	
C 5	55	3.20	55	24		144

CPH Lounge						
	sqm	Height	Row	Parliament	Banquet	Reception
Total	100	3.20	40	-	70	-



Event technology

With its event technology and staff, CPH is just as well positioned for digital and hybrid events as it is for live events. There is sufficient scalable space and attractive rooms to make the attended areas of hybrid events compliant with coronavirus conditions.

Our particular strength is thorough planning and extensive consultation. The CPH technical team carries out the planning and interpretation in close coordination with the event organizer.

- ▶ Live streaming
- ▶ Hybrid congresses and meetings
- ▶ Virtual trade fairs and product presentations
- ▶ Events both live and conventional

EVENT TECHNOLOGY

LIVE STREAM AND MULTIMEDIA

- 
- ▶ Broadband fibre optic connections performing at up to 100 MBits
 - ▶ Structured network cabling
 - ▶ WLAN network with the 802.11ac standard
 - ▶ Modern, intelligent camera technology – remote-controlled, with integrated tracking function or operated by camera staff
 - ▶ Directing and editing suites
 - ▶ Presentation and preview systems
 - ▶ Stage lighting adapted to the camera
 - ▶ Mobile audio, video, projection and lighting technology

GREEN MEETINGS WELCOME

When it comes to climate protection, every contribution counts. There are numerous approaches to conserving resources during conferences and events. We apply those approaches so that our customers at CPH can organise their events in a way that is sustainable and climate friendly. The guidelines of „fairpflichtet“, the sustainability code of the German-speaking events industry, help us to do just that. We are also available to provide event organizers with advice and support to ensure, that events at CPH are as environmentally and climate friendly as possible.

Thanks to our cooperation with „natureOffice“, it is possible to realize completely climate neutral events at the CPH.



METROPOLITAN AREA

FRANKFURT RHINE-MAIN



► CONGRESS PARK HANAU

Schlossplatz 1 | 63450 Hanau, Germany

Phone +49 (0) 61 81 - 277 50

info@cph-hanau.de

www.cph-hanau.de/en

